

1 DEMOLITION FLOOR PLAN
1/4" = 1'-0"

DEMOLITION GENERAL NOTES:

- A. THE CONTRACTOR SHALL PROTECT ADJACENT SPACES FROM DUST & DEBRIS GENERATED BY DEMOLITION ACTIVITIES.
- B. THE CONTRACTOR SHALL FIELD VERIFY EXISTING CONDITIONS PRIOR TO COMMENCING WORK. CONFLICTS AND/OR OMISSIONS SHALL BE IMMEDIATELY REPORTED TO THE ARCHITECT FOR CLARIFICATION PRIOR TO STARTING THE WORK IN QUESTION.
- C. THE CONTRACTOR SHALL OBTAIN ALL PERMITS AND INSPECTIONS. COMPLY WITH ALL CODES, LAWS, ORDINANCES, RULES AND REGULATIONS OF ALL PUBLIC AUTHORITIES (FEDERAL, STATE OR LOCAL) GOVERNING THE WORK. THE MOST STRINGENT SHALL APPLY.
- D. DEMOLITION SCHEDULE AND WORK HOURS SHALL BE COORDINATED WITH THE OWNER PRIOR TO STARTING THE WORK.
- E. CONTRACTOR TO COORDINATE EXISTING ITEMS TO BE RETAINED BY THE COURTHOUSE.
- F. PROVIDE, ERECT, AND MAINTAIN TEMPORARY BARRIERS AND SECURITY DEVICES.
- G. CONDUCT OPERATIONS TO MINIMIZE EFFECTS ON AND INTERFERENCE WITH ADJACENT STRUCTURES AND OCCUPANTS.
- H. CONDUCT OPERATIONS TO MINIMIZE OBSTRUCTION OF PUBLIC AND PRIVATE ENTRANCES AND EXITS. DO NOT OBSTRUCT REQUIRED EXITS AT ANY TIME. PROTECT PERSONS USING ENTRANCES AND EXITS FROM REMOVAL OPERATIONS.
- I. CONTRACTOR TO REMOVE ALL DEBRIS, JUNK AND TRASH FROM THE SITE ON A DAILY BASIS THROUGHOUT THE DURATION OF THE PROJECT.
- J. LEAVE SITE IN CLEAN CONDITION, READY FOR SUBSEQUENT WORK.
- K. FOR ALL EXISTING ITEMS INSTALLED IN WALLS / CEILINGS / FLOORS THAT ARE TO BE REMOVED - VERIFY IF THEY NEED TO BE RETAINED FOR REINSTALLATION.
- L. CONTRACTOR TO VERIFY EXISTING CEILING TYPE CONSTRUCTION.
- ADD 001 REMOVE EXISTING SHOE MOULDING FROM ALL MILLWORK AND PERIMETER OF ROOM.

DEMOLITION PLAN SYMBOLS

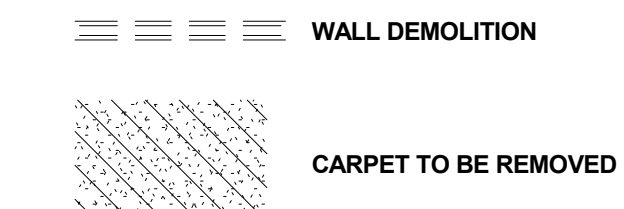

DEMO WILL BE COMPLETED IN PHASES. THE COURTROOM MUST REMAIN OPEN WITH COMPLETE FUNCTIONALITY.

KEYNOTE LEGEND

KEY	NOTE
AD.08	REMOVE EXISTING VIDEO CAMERA AND MONITOR AND TURN OVER TO OWNER. PATCH AND REPAIR WALL CAP ELECTRICAL POWER & DATA. INSTALL PAINTABLE COVER PLATES.
AD.09	EXISTING EMERGENCY NOTIFICATION DEVICE TO BE RELOCATED. SEE SHEET A102. CAP EXISTING POWER AND DATA CONNECTIONS. INSTALL PAINTABLE COVER PLATES.
AD.10	WALL MURALS TO BE REMOVED BY OWNER.
AD.11	PODIUM STAND, TO TURN OVER TO OWNER.
AD.12	PROJECTOR CART, TURN OVER TO OWNER.
AD.13	REMOVE WOOD BENCH WALL COMPLETELY.
AD.14	COURT TECHNOLOGY CART, DEVICES, AND WIRING TO BE REMOVED BY OTHERS UNDER SEPARATE CONTRACT.
AD.15	REMOVE WOODEN STAIRS
AD.16	REMOVE COUNTER
AD.17	REMOVE PORTION OF WITNESS STAND INCLUDING FLOOR & STRUCTURE, WEST & SOUTH MILLWORK WALLS, COUNTER AND CAP ELECTRICAL/DATA CONNECTIONS AT FLOOR.
AD.18	JUDGE BENCH MILLWORK PARTITION TO BE PARTIALLY DEMOLISHED. REFER TO DETAILS SHEET A502.
AD.19	REMOVE & REINSTALL FIXED SPECTATOR BENCH SEATING AND JURY SEATING. REMOVE & REINSTALL ALL LOOSE FURNITURE INCLUDE ATTORNEY TABLES, CHAIRS, DESKS AND TABLES. CARPET TO BE REMOVED AND REPLACED THROUGHOUT ENTIRE ROOM.
AD.20	CORE DRILLING FOR NEW ELECTRICAL/DATA FLOOR BOXES. SEE E102 FOR ELEC. INFORMATION.
AD.21	JUDGE BENCH DEMO. STARTING POINT
AD.22	COUNTER CORNER TO BE CUT AND REUSED. SEE ENLARGED PLAN SHEET A402.
AD.23	TYPICAL (6) TABLE. REMOVE MODESTY CURTAIN FROM UNDERSIDE OF TABLE. CUT IN OPENING AT THE TABLE TOP FOR NEW ELECTRICAL/DATA. EXISTING GLASS TOP TO BE REMOVED, OPENINGS CUT TO MATCH NEW TABLE TOP OPENINGS AND REINSTALLED.
AD.24	NEW FLOOR BOX OPENINGS SEE ELEC. SHEET E102.
AD.25	CUT METAL RING ABOVE CONCRETE AND GRIND SURFACE SMOOTH.
AD.26	EXISTING FLOOR BOXES TO BE DEMOLISHED AND FILLED WITH CONCRETE TO MATCH WITH EXIST. CONCRETE LEVEL.

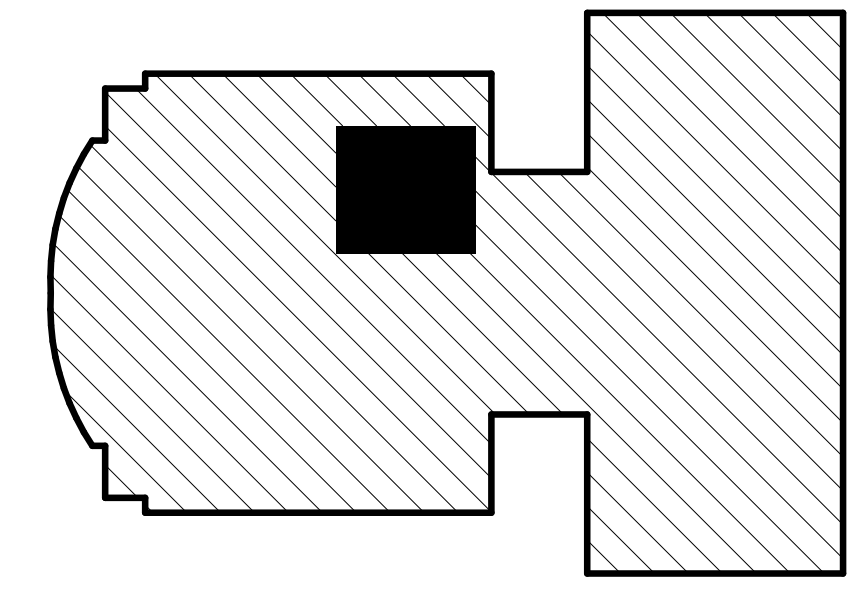

KEY PLAN

Technology and Millwork Upgrades

Genesee County Purchasing Department

PRELIMINARY - NOT FOR CONSTRUCTION

SEAL

ADD 001 10/19/2016 ADD-001

DRAWN MSP
APPROVED HP
ISSUED FOR CONSTRUCTION
DATE 10/10/2016
FIELD BOOK

PROJECT NO.: 8151060

DEMO FLOOR PLAN

D102